

The background of the slide is a composite image. The top and bottom portions show a view of Earth from space, with swirling white clouds and blue oceans. In the center, overlaid on the globe, is the official seal of the University of South Florida. The seal is circular and features a central figure holding a torch and a book, surrounded by the Latin motto 'WISDOM IN DEO' and the words 'UNIVERSITY OF SOUTH FLORIDA'.

Philanthropy Impacts

THE UNIVERSITY OF SOUTH FLORIDA



Philanthropy Impacts...USF

from the president

Friends,

As a supporter of the University of South Florida, you understand the impact your philanthropy has on this great institution. Your place in such an influential group of donors does not occur by accident. We are honored by your support because you give with purpose, you give with passion, and you believe that your investment in USF is an act of faith and a belief that tomorrow's world will be better because one person can make a difference.

I can say with extreme confidence that your support of USF is making a difference in our world today. The pages that follow exemplify the impact your philanthropy has at USF. The results of your generosity are astounding and are changing lives.

For this reason, the University of South Florida is inspired by your actions and compelled to make good on your intentions. I am honored to celebrate your spirit of giving.

Thank you for all you do for the University of South Florida.

JUDY GENSHAFT / PRESIDENT

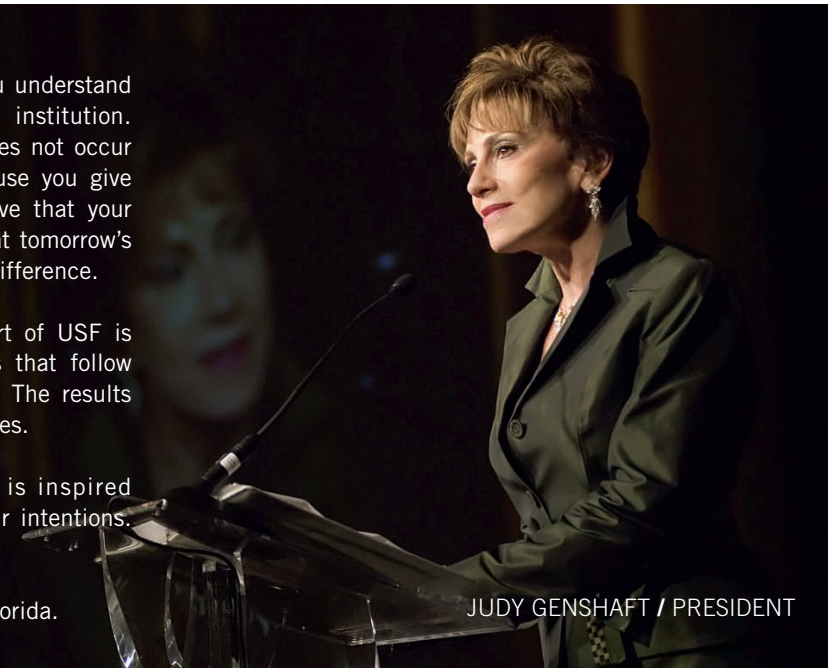



Philanthropy Impacts: innovation

You make it possible for great thinkers to aspire to innovate. Today's world-class universities understand that the best education requires interplay between university research, high technology, and community engagement, linked together by eminent scholars and dedicated staff.

At USF, we approach education through innovation and push the limits of knowledge every step of the way. USF is acknowledged as one of the fastest growing universities in the beginning of the 21st century. The driving force of innovation has brought us to this threshold and will guide us well into the future.

innovation



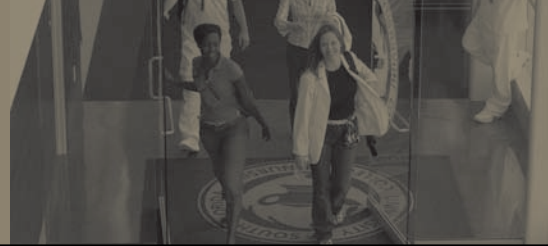

Philanthropy Impacts: healthcare solutions

USF Health is a leader in the pursuit for a cure for Alzheimer's disease and other diseases of the mind through the work of outstanding researchers and physicians. USF Health is an innovator, joining the talents of Tampa General Hospital and the USF College of Medicine to create the state's most advanced neonatal care center, designed to eradicate infant mortality. USF Health is a pioneer, creating a teaching model, unlike any in the country, to educate and train doctors, nurses and healthcare specialists using a team approach. This model simulates how they will work together in the real world.

All of these advancements in USF Health are possible because of philanthropy. And that same generosity is the reason our physicians are regarded as the best in the world in their disciplines. Our research is groundbreaking and saving lives every day. And our partnerships with the region's top hospitals and a world-renowned cancer center provide a level of healthcare that goes unmatched by most standards.

healthcare solutions





Philanthropy Impacts: global outreach

The spirit of USF's global impact can be seen through the diversity of our students, our presence throughout the world, and our educational opportunities that expand beyond our borders. The global community is our classroom, and we understand our relevance and our role in making it a better place for all.

At the forefront of this effort is *The Dr. Kiran C. Patel Center for Global Solutions*. Founded through the vision of two philanthropists whose touch can be felt worldwide, the Center seeks viable solutions to challenges facing developing countries.

It is that same generosity and vision that drive the forces of change in our world. Yes, one person can change the world through giving with purpose, and our donors lead by example.

global outreach





Philanthropy Impacts: emerging technology

Private investment in technology can be the springboard for taking new technology into the marketplace.

USF's technological advancements transform the way we secure our national borders, explore the human body, and pave the way to better transportation systems. These applications in the everyday world

are limitless and highly interdisciplinary, drawing creativity and innovation from an incredible pool of talent throughout the University.

USF's rate of technology transfer gains momentum every day, and the world's technology industry has taken notice. The technologies of tomorrow are very real at USF today.

emerging technology



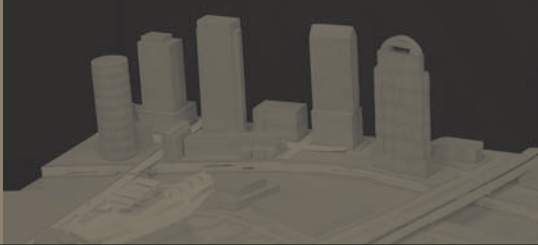

Philanthropy Impacts: our communities

Your support of community initiatives at USF benefit the University and the communities we serve.

We are in the rural communities and inner cities, providing free healthcare screening and innovative learning opportunities for our most at-risk children. We are in your environment, finding solutions to cleaning the air we breathe, restoring our precious wetlands, and preserving the world's

natural resources. We are in government, providing expertise on how to grow and strengthen our communities in ways that won't overburden infrastructure and stay focused on the future.

Your investment in USF – our faculty, students and alumni – can be found influencing the quality of life in communities everywhere.

our communities



Thank You
for your confidence in and support of the University of South Florida.



PRODUCED BY

Advancement Communications / Jeremy Canody

PHOTOGRAPHY

University Relations / Joseph Gamble

DESIGN

G Squared Design Solutions, Inc.



Office of Development
Gibbons Alumni Center
4202 East Fowler Avenue, ALC100
Tampa, Florida 33620
(813) 974-2651 / www.giving.usf.edu